

PART No.	DRG No.	UNIT	LENGTH	FINISH
AA4060	M3800D	ML5-SC	765+0.5	PAINT

M4 X 16 TAP BOTH ENDS

M6 X 25 TAP BOTH ENDS

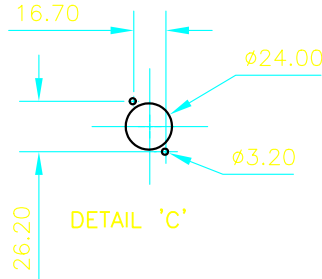

ADD 33MM FOR DIM TO THE OUTSIDE OF MOULDING + SIDE ELEVATION SCALE 2:1

ADD 33MM FOR DIM TO THE OUTSIDE OF MOULDING

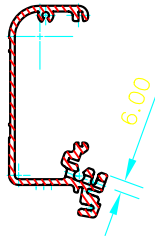
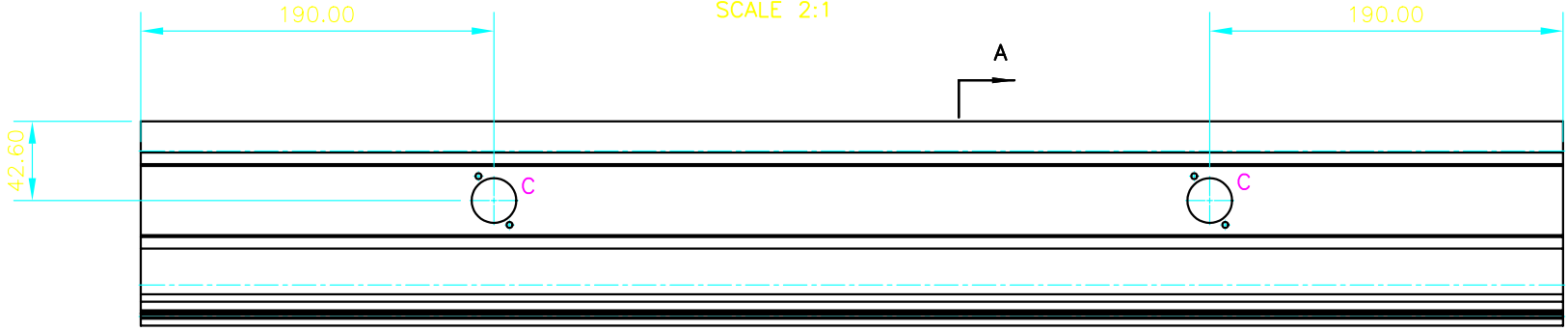
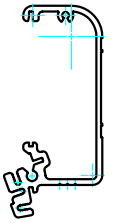

A-A

HOLE $\phi 4.00$

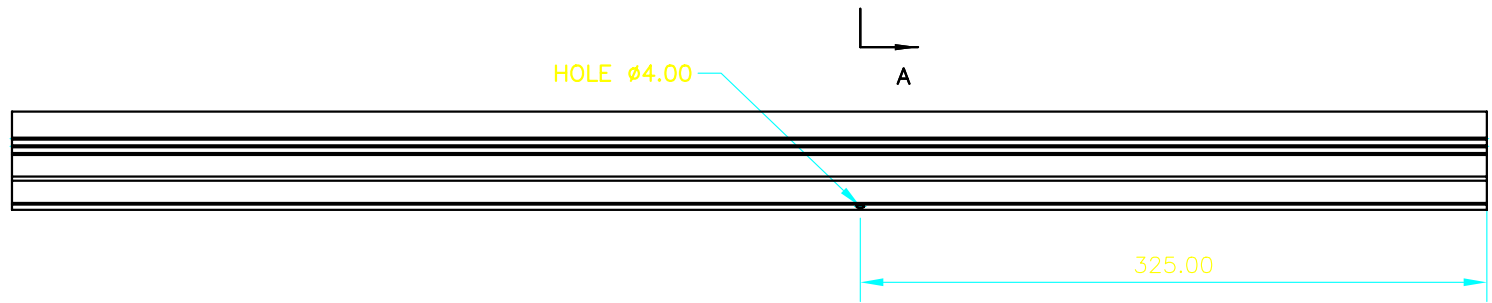

ISSUE	REVISION	DRAWN	DATE	NOTES:
1	PRODUCTION	NM	17-03-00	
2	HOLE DIMS CHANGED	NM	23-06-00	

TOLERANCES U.O.S.:
 GENERAL ± 0.25
 HOLE CENTRES ± 0.10
 HOLE SIZES $+ 0.05$
 ANGULAR DIMS $\pm 0.50^\circ$
 ALL DIMENSIONS IN MM U.O.S.

MATERIAL:
 N/A

FINISH:
 N/A

DRAWING
 METERPOD EXTRUSION FABRICATION

UNIT
 ML5SC

PART No.
 AA4060

DRAWING No
 M4060 Sheet 1 of 1

ALLEN & HEATH
 KERNICK INDUSTRIAL ESTATE
 PENRYN CORNWALL TR10 9LU
 A HARMAN INTERNATIONAL COMPANY

TELEPHONE 01326 3720
 FACSIMILE 01326 3757

ISSUE
 2