

THIRD ANGLE
PROJECTION

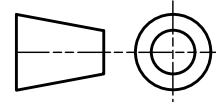

TOLERANCES U O S:
GENERAL ± 0.25 HOLE CENTRES ± 0.10
HOLE SIZES ± 0.05 ANGULAR DIMS ± 0.50°

GR4
Height 48mm (1.9")
Length 242mm (9.5")
Width 438mm (17.2")
Weight 3.4kg (7.5lbs)

GR4 Packaged
Height 200mm (7.9")
Length 340mm (13.4")
Width 530mm (20.9")
Weight 4kg (8.8lbs)

DRAWING

WEIGHTS AND DIMS

UNIT

GR4

ALLEN & HEATH Ltd.
KERNICK INDUSTRIAL ESTATE
PENRYN CORNWALL TR10 9LU
TELEPHONE 01326 372070
FACSIMILE 01326 370153